

ENGINEERING LABORATORIES.

Basement, 18,500 Square Feet.

LIST AND NAMES OF MACHINES ON FLOOR PLANS.

Complex steam pump, 16" x 10 1/2" x 12"  
 Sump pump  
 Sewer pump  
 Drain pump  
 Centrifugal pump  
 Thermometer  
 Weighing tanks  
 Large testing apparatus  
 Galvanized steel tanks, each 280 cubic feet capacity  
 High water meter

104 Fan engine  
 105 Main coils for heating and ventilating system  
 106 Rope testing machine  
 107 Emery testing machine, 300,000 lbs. capacity  
 108 Scale case for Emery testing machine  
 109 Power hydraulic pump for Emery testing machine  
 110 Beam testing machine, 100,000 lbs. capacity, 26 ft. span  
 111 Beam testing machine, 18,000 lbs. capacity, 14 ft. span  
 112 Gas engine  
 113 Torsional shaft testing machine  
 114 Air brake apparatus for 26 car train

115 Surface condenser  
 116 Westinghouse single acting engine, 35 H. P.  
 117 Locomotive air pumps  
 118 Chain drive testing machine  
 119 Machine for testing wear of brake shoes and of tires  
 120 Combination air brake  
 121 Iron rack  
 122 Experimental fly wheel governor  
 123 Experimental pendulum governor  
 124 Machine for testing coefficient of sliding friction  
 125 Machine shop

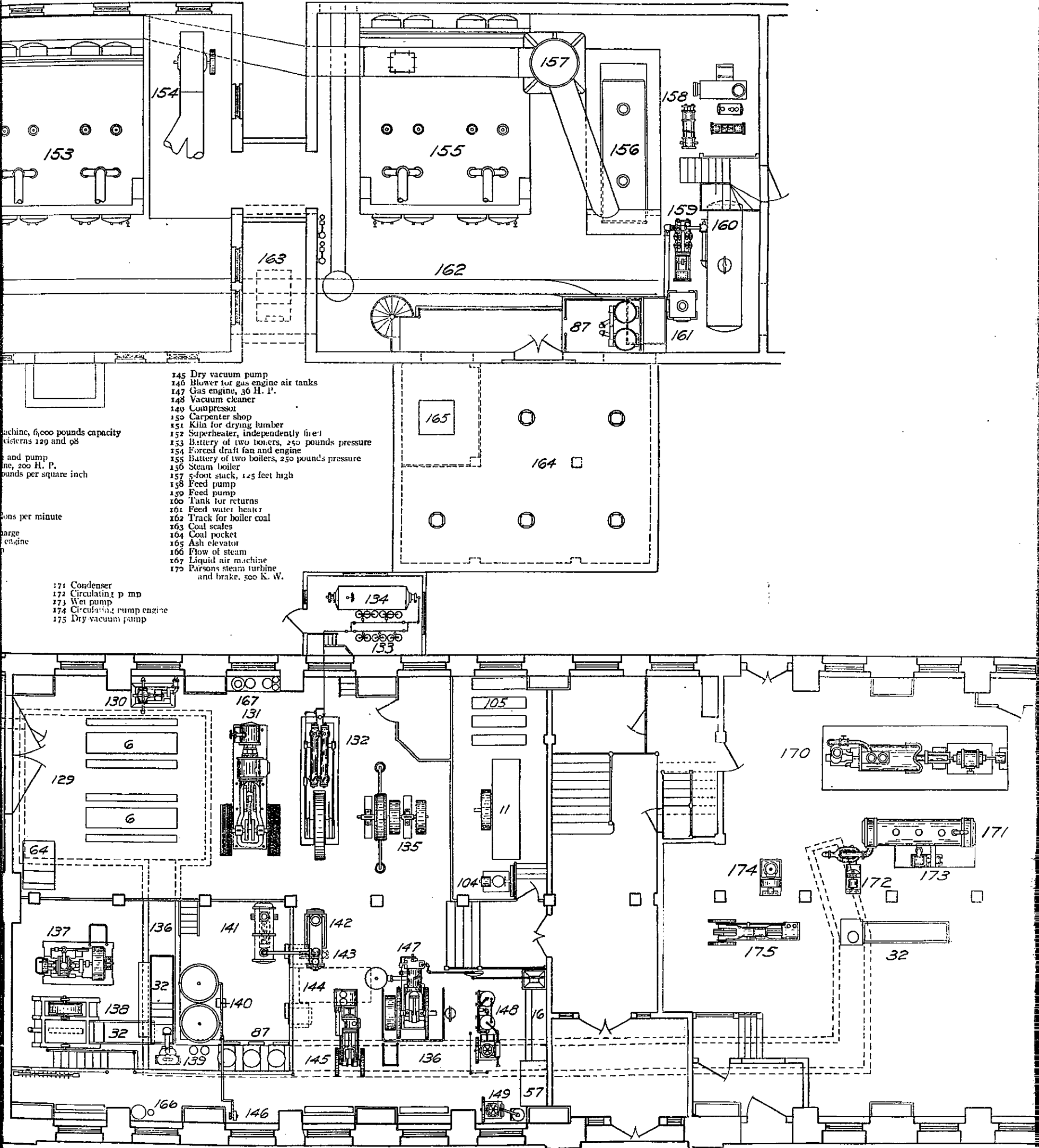

145 Dry vacuum pump  
 146 Blower for gas engine air tanks  
 147 Gas engine, 36 H. P.  
 148 Vacuum cleaner  
 149 Compressor  
 150 Carpenter shop  
 151 Kiln for drying lumber  
 152 Superheater, independently fired  
 153 Battery of two boilers, 250 pounds pressure  
 154 Forced draft fan and engine  
 155 Battery of two boilers, 250 pounds pressure  
 156 Steam boiler  
 157 5-foot stack, 125 feet high  
 158 Feed pump  
 159 Feed pump  
 160 Tank for returns  
 161 Feed water heater  
 162 Track for boiler coal  
 163 Coal scales  
 164 Coal pocket  
 165 Ash elevator  
 166 Flow of steam  
 167 Liquid air machine  
 170 Parsons steam turbine and brake, 500 K. W.

171 Condenser  
 172 Circulating pump  
 173 Wet pump  
 174 Circulating pump engine  
 175 Dry vacuum pump

Machine, 6,000 pounds capacity  
 Cisterns 129 and 98

and pump  
 H. P.  
 pounds per square inch

ons per minute  
 charge  
 engine