



Novartis Institutes for BioMedical Research | Site Plan
 Michael Van Valkenburgh Associates, Inc., Landscape Architects
 21 August 2012



Novartis Institutes for BioMedical Research | Massachusetts Avenue Entry Plaza | Plan
 Michael Van Valkenburgh Associates, Inc., Landscape Architects
 21 August 2012





Novartis Institutes for BioMedical Research | Massachusetts Avenue Entry Plaza | View 1 (Open)
Michael Van Valkenburgh Associates, Inc., Landscape Architects
21 August 2012



Novartis Institutes for BioMedical Research | Massachusetts Avenue Entry Plaza | View 1 (Closed)
Michael Van Valkenburgh Associates, Inc., Landscape Architects
21 August 2012



Novartis Institutes for BioMedical Research | Massachusetts Avenue Entry Plaza | View 2 (Open)
Michael Van Valkenburgh Associates, Inc., Landscape Architects
21 August 2012



Novartis Institutes for BioMedical Research | Massachusetts Avenue Entry Plaza | View 2 (Closed)
Michael Van Valkenburgh Associates, Inc., Landscape Architects
21 August 2012

WINDSOR STREET



**211
Massachusetts
Avenue**

Terrace

Accessible Walkway

**Stairs w/
Handrails**

Property Line

Roof Overhang

**Folding Gate
w/ (2) 5'-0" Sections
@ Each Side of Post,
Typ. of 3**

**22
Windsor
Street**



Novartis Institutes for BioMedical Research | Windsor Street Entry | Daytime (Open)
Michael Van Valkenburgh Associates, Inc., Landscape Architects
21 August 2012



Novartis Institutes for BioMedical Research | Windsor Street Entry | (Closed)
Michael Van Valkenburgh Associates, Inc., Landscape Architects
21 August 2012

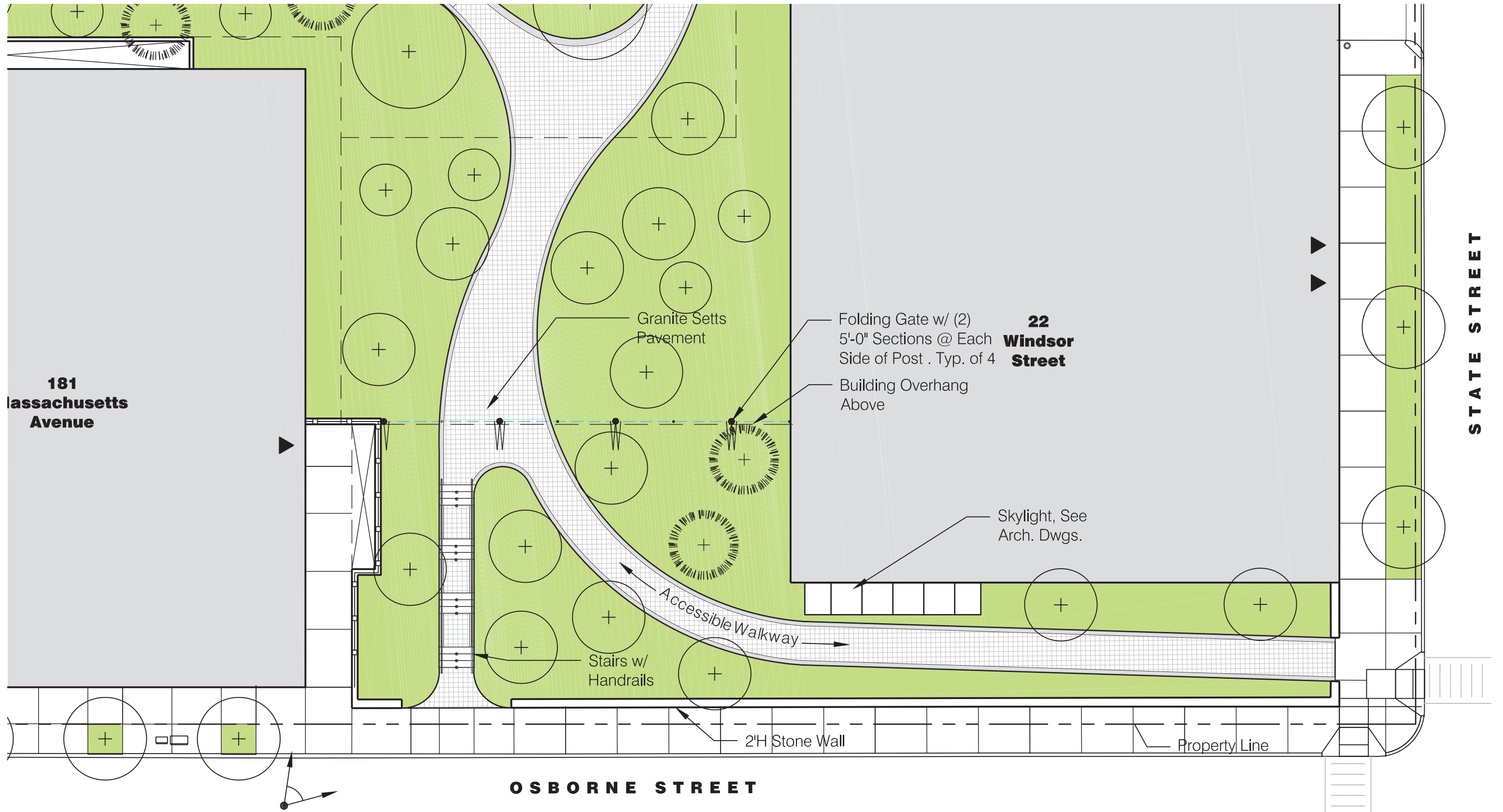



Novartis Institutes for BioMedical Research | Osborne Street Entry | Daytime (Open)
Michael Van Valkenburgh Associates, Inc., Landscape Architects
21 August 2012



Novartis Institutes for BioMedical Research | Osborne Street Entry | (Closed)
Michael Van Valkenburgh Associates, Inc., Landscape Architects
21 August 2012